



# FM-SPH PUMP

## STRONG, RELIABLE PERFORMANCE



Engineered and built for pool professionals

- 1) Asynchronous, two pole motor
- 2) Class insulation 155(F)
- 3) Thermal and over current protection
- 4) Pump casing ABS + glass fiber, Impeller PPO, Strainer basket and base in PP + glass fiber
- 5) Motor shaft - SS316, Seals bellows - EPDM, stationary face - SIC, rotating face - Graphite, Spring - SS316
- 6) Self-Priming up to 3.3m above water level
- 7) Testing pressure 50 PSI (3.5 Bar)
- 8) Basket Volume 2 litres



45 - 47 Paul Matthews Road, Albany Auckland New Zealand

Phone: (09) 415 1499 Fax: (09) 415 1498

Email: [filtermaster@xtra.co.nz](mailto:filtermaster@xtra.co.nz) Web: [www.filtermaster.co.nz](http://www.filtermaster.co.nz)

**FULLY NEW ZEALAND OWNED AND OPERATED**

## Technical Information

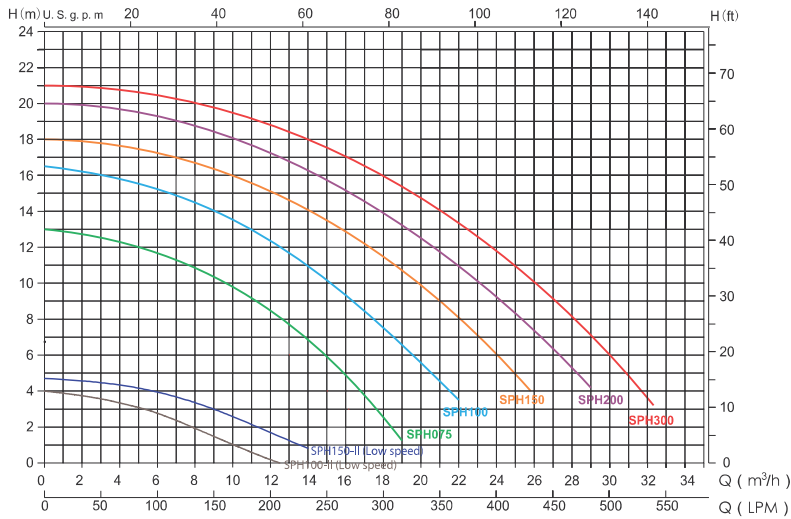

Model 50Hz	Input (kW)	Current (AMP)	Noise (dB)	Head (m)					
				6	8	10	12	14	16
SPH075	0.75	3.5	65	15	12.5	9.5	5	--	--
SPH100	1.10	5	65	19.5	17.5	15.2	12.5	9	3
SPH150	1.50	6.8	67	24	22	19.9	17.5	14	10
SPH200	1.80	8.2	67	27.5	25.5	23	21.7	18	14.5
SPH300	2.20	10	68	30	28.5	26	23.8	21	18

## Product Dimension

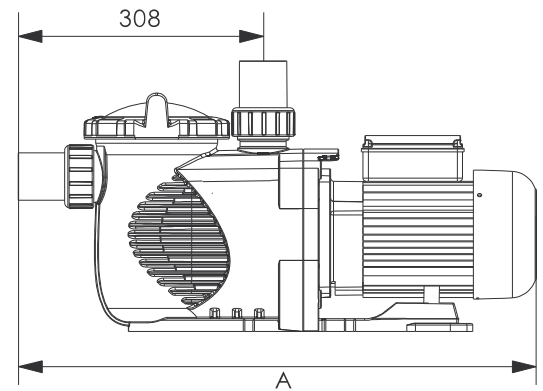
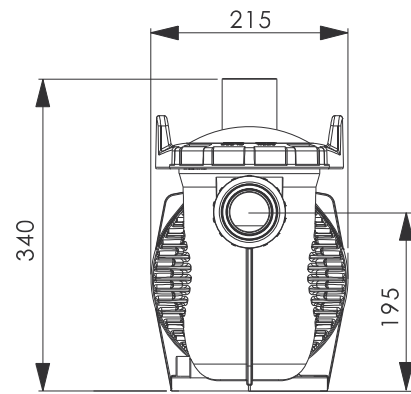

Code 220V/50Hz	Code 220V/60Hz	Model	Connection Size	Horsepower	Weight(kg)	Capacitance 220V	A (mm)
88029604	88029704	SPH075	1.5"(50mm)ID / 2"(63mm)OD	0.75hp	13.6	20µF	652
88029605	88029705	SPH100	1.5"(50mm)ID / 2"(63mm)OD	1.0hp	13.8	25 µF	652
88029607	88029707	SPH150	1.5"(50mm)ID / 2"(63mm)OD	1.5hp	14.0	25 µF	652
88029608	88029708	SPH200	1.5"(50mm)ID / 2"(63mm)OD	2.0hp	14.2	30 µF	652
88029609	88029709	SPH300	1.5"(50mm)ID / 2"(63mm)OD	3.0hp	14.5	35 µF	682

Filtermaster warranty on this product.  
All parts 2 years.  
Infield Labour cost (if applicable). 1 year



[www.filtermaster.co.nz](http://www.filtermaster.co.nz)

